

Changing the filter cartridge

Commissioning instructions

Uncommissioned systems (re-filters) that have been transported and stored below 0°C must be stored in open original packaging at least 24 hours before commissioning at the ambient temperature of the installation site.

Please observe the technical data and the operating and safety instructions of the operating instructions before commissioning.

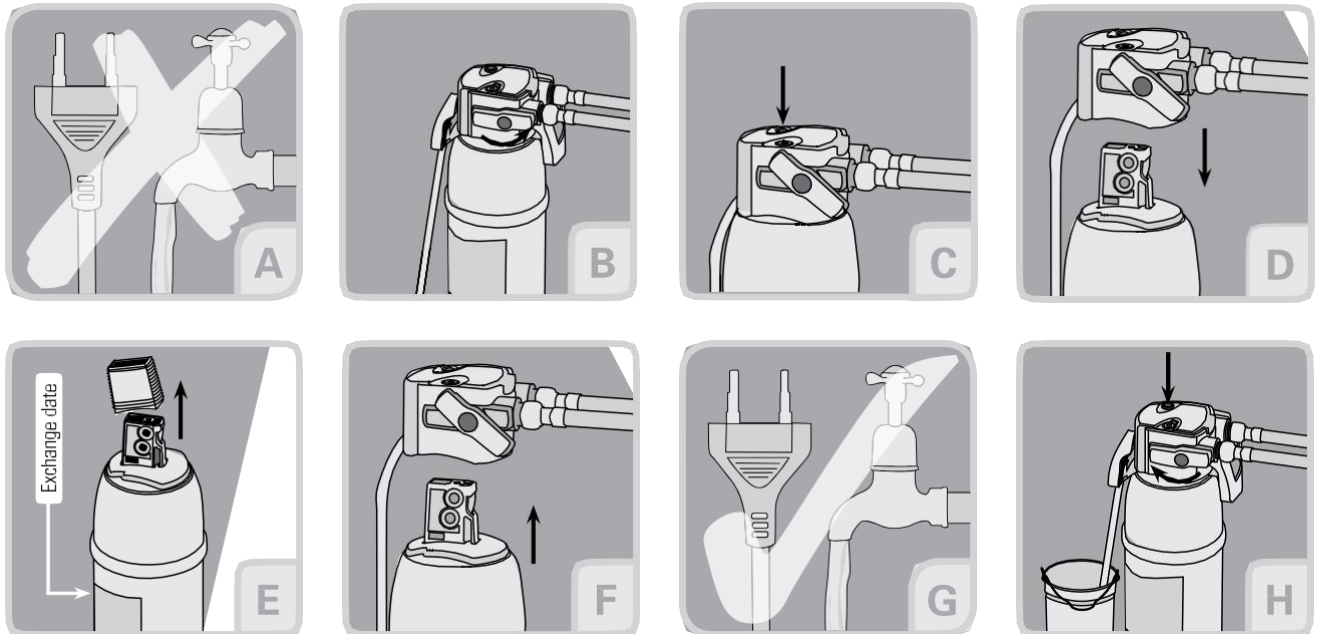

Changing the filter cartridge

- A. Close the water supply and, if necessary, switch off the existing power supply of the terminal device.
- B. Open the locking handle.
- C. Operate the flush valve "Flush valve" and remove pressure from system.
- D. Remove the used filter cartridge from the filter head.
- E. Remove the tab from the protective cap of the filter cartridge upwards, remove the protective cap. Note the next exchange date in date field on filter cartridge.
- F. Open the lock on the filter head. Insert the filter cartridge vertically into the filter head and pay attention to the correct position. Then turn the locking handle to the noticeable locking.
- G. water supply and, if necessary, open the water supply. switch on the existing power supply of the terminal device.
- H. Actuate the flushing valve "Flush valve" and rinse the filter system until the filtered water runs out without a bubble. Rinse at least 5.4 l.

Note: When venting / rinsing from flushing hose, collect water leaking from the flushing hose in a suitable container and check the system for possible leaks.